



Brändön Lodge and the Treehotel - Aurora Short Break



HOLIDAY TYPE: Flexible Dates
VISITING: Sweden

BROCHURE CODE: 26120
DURATION: 3 nights

In Brief

Discover the pristine wilderness of Swedish Lapland from two exceptional bases. Spend two nights at Brändön Lodge in a cosy winter cottage overlooking the frozen Bothnian Bay before ending your holiday in spectacular style with a night at the world-famous Treehotel. Your days have been left completely free for you to tailor your time with your dream winter experiences.

Our Opinion

“ *This really is the ultimate Swedish Lapland experience. From cosy winter cottages in a winter wonderland to an unforgettable night at the Treehotel - something you must see for yourself to believe!* ”

Amy Hope



What's included?

ALL OF THE ACTIVITIES AND SERVICES LISTED BELOW ARE INCLUDED IN THE HOLIDAY PRICE

- **Transfers:** return airport transfers from Luleå Airport
- **Accommodation:** 2 nights in a winter cottage at Brändön Lodge and 1 night at the Treehotel (Bird's Nest, UFO, or Blue Cone included. Other rooms will require a supplement)
- **Meals:** 3 breakfasts, 2 lunches, 3 dinners
- **Activities:** choose from our extensive range of activities (individually priced in the '[Personalise](#)' section of the holiday page)
- Cold weather clothing during your stay at Brändön Lodge
- Services of our expert local guides
- **A note about flights:** flights are not included in the holiday price so that the best possible fares and schedule can be found at the time of booking

Trip Overview

Swedish Lapland is one of the last untouched wilderness regions in Europe and at Brandon Lodge, you'll discover just how pristine this part of the world is. Situated in the coastal area of Lulea, your views span across the Bothnian Bay, which freezes solid during winter to transform into a snowy playground for unforgettable activities.

Your two nights at Brändön Lodge put you in a fantastic location for all the key winter experiences. From husky sledding across the frozen trails to gaining an authentic insight into the fascinating Sámi culture and the much-loved animals of Lapland during a reindeer experience day - take a look at the 'activities' tab to design your ideal itinerary. It's been said that there is a real magic in the air here and as darkness falls, you'll hopefully see it for yourself as you will be in prime Northern Lights territory. Step outside of your cosy accommodation or choose from an array of dedicated Aurora activities to increase your chances of seeing a mesmerising display.

For your final night, you'll see why the Swedish are known for their impeccable architecture during an unforgettable night's stay at the Treehotel. Renowned for its innovative design, the hotel is one of the most sought-after accommodations in the region and you will spend the night in one of the

spectacular concept rooms situated amongst the treetops. Each room has a unique theme, covering everything from a bird's nest to a UFO!

In just three nights, you can get the full experience of life in Lapland and tick of some phenomenal bucket list items along the way.

Image credits: Sally Hickinson, Brändön Lodge, Graeme Richardson, Andreas Walitalo, Quinten Elpers

Interreg
Nord

European Regional Development Fund



EUROPEAN UNION

Agenda

Please note the order of activities is subject to change

DAY
1

ARRIVAL AND WELCOME

Arriving at Luleå Airport, you will be transferred approximately forty minutes to your winter cottage accommodation at Brändön Lodge.

After settling into your accommodation, enjoy dinner in the restaurant. You may wish to book a Northern Lights activity for this evening or spend a night relaxing in your new surroundings - either way, we recommend keeping an eye on the sky as you are now firmly in the Aurora Zone.

Included Meals: Dinner

DAY
2

FREE DAY

Today has been left completely free for you to spend as you please. You could complete your winter experience with one of the top activities such as husky sledding or snowmobiling - see the '[Personalise](#)' tab for more information. All meals will be served in the hotel restaurant. As darkness falls, make sure you peek outside for a chance to spot the Northern Lights.

Included Meals: Breakfast, Lunch, Dinner

DAY
3

FREE MORNING AND NIGHT AT THE TREEHOTEL

Enjoy breakfast and lunch in the hotel restaurant and a free morning to squeeze in another activity or simply enjoy the pristine surroundings. Then it's time to bid farewell to Brändön Lodge and transfer to the fantastic Treehotel, approximately an hour and a half away.

You will check into your unique room and have time to settle in before enjoying a three-course dinner in the homely guesthouse. Afterwards, we recommend making your way back to your room to enjoy this exceptional accommodation amongst the Lappish forest - all the while keeping an eye on the sky as the Northern Lights are frequently seen here! Please note, the Bird's Nest, UFO and Blue Cone rooms come as standard, other rooms require a supplement. Please speak to our Aurora Travel Experts if you would like to upgrade.

Included Meals: Breakfast, Lunch, Dinner

DAY
4

DEPARTURE

Today after breakfast it is sadly time for your short break in Sweden to come to an end. If you have an early flight time, we will box up breakfast for you to take with you.

Included Meals: Breakfast

Personalise this tour

Our pick



Full Day Dog Sledding Self Drive

This tour is for adults only, so if you fancy something more active, then this full-day dog sledding tour certainly offers that.

You'll transfer to a husky farm, approximately 1 hour away, where you will be given expert guidance and tuition on how to control your team of dogs and how to drive the sled. You'll ride two people per sled, with several chances to swap drivers along the way, travelling through snow-covered forests and frozen lakes.

The tour involves approximately 4 hours of dog sledding, with breaks along the way, covering between 30-50km, depending on conditions. The tour also includes a wilderness lunch, cooked over an open fire and you will also get to spend some time with the dogs during and after the tour; a great photo opportunity!

Please note that the price does not include the cost of the transfer – please speak to one of our Travel Experts for a full quotation.

Duration: 6 hours in total (including transfers), approximately 4 hours of dog sledding (including lunch break)

Photo credit Graeme Richardson

Other options

ACTIVITIES



Arctic Astronomy

After an early dinner, you will have a short transfer to the nearby home of Ulf Jonsson, an amateur consultant of aviation, space and photography who has built his own small, but fantastic, observatory.

Ulf will take you through the range of binoculars and telescopes on offer. Then, the roll-away roof will reveal the night sky and you'll get a brilliant view of the wonders overhead.

Ulf will point out constellations and explain how different cultures perceive the stars. If the moon is visible, you can track along the surface to observe the craters and mountain ranges. Of course, the real highlight in this part of the world is the Northern Lights and if conditions are favourable, you may get one of the most detailed views of this wonder. Should the Auroras appear, Ulf will also help you with your camera settings to capture this special moment.

Duration: 3 hours, including transfers

Photo credit Juo Foto



Cross Country Skiing

Have some fun in the snow as you learn how to travel across the frozen wilderness just like the locals do. During this cross-country skiing activity, you'll explore the winter wonderland surroundings of the lodge and get a real back-to-nature experience of the Lappish landscape.

Your local guide will teach you all the techniques needed to use the cross-country ski equipment. Then, once you are fitted with your skis, you will follow your guide along the snowy trails.

The weather and snow conditions will determine which route you will take - either along the solid-frozen sea, through the enchanting forest or gliding across the specially-carved snowmobile tracks. You will also stop to warm up with hot drinks along the way and enjoy the peaceful surroundings.

Duration: 2 hours

Photo credit Quinten Elpers



Northern Lights Sled Tour

Enjoy a speedy search for the Northern Lights where you can relax at the same time. As you sit back on cosy reindeer pelts in a sled, your guide will pull you along with their snowmobile. Heading over the ice, you will journey between islands in your search for the Aurora. You'll make a stop for warm drinks and snacks around an open fire, as you search the skies for the Aurora

Duration: 2 hours (includes hot drinks)

©Graeme Richardson



Nordic Winter Skills

Having learned how to fasten snowshoes, you will be taken by a guide on a three-hour trek over the nearby trails. They will share their knowledge about the local flora and fauna and also show you different animal tracks in the snow. Making a stop, you will be taught how to set up a small fire and prepare a hot drink in the wilderness. You will have a break at a 'kota' (teepee) and enjoy a delicious lunch which will be cooked by your guide on an open fire.

Duration: 3 hours



Sámi reindeer experience

Gain an authentic insight into the Sámi culture and learn all about the significance of reindeer in the Arctic during this Sámi reindeer experience day.

You will meet with Henrik Andersson, a local Sámi man who will show you his way of life as you learn all about his culture.

Taking the short walk from Brändön Lodge to the reindeer enclosure, Henrik will talk to you about the life of these wonderful animals, the eight seasons of the region

and how nature plays a major role in life in the Arctic.

You will then walk with the reindeer into the forest and towards a Sámi tent. Here, you will sit around an open fire with a hot drink and talk more with Henrik before enjoying a lunch of fresh and traditional ingredients.

Duration 2.5 hours starting at 10am

Available: 18 Dec 2020 – 04 Apr 2021

Image Credit: Lola Akinmade Akerstrom



Icebreaker

The frozen sea is a sight to behold. A vast, thick sheet of shimmering white, stretching out far into the distance, it is hard to believe that the ocean lies below. The ship then cuts through the ice with apparent ease and suddenly the water is revealed. Shards of Ice surround the boat and you would be forgiven for wondering whether you are on an expedition to Antarctica. The title of the ship 'Arctic explorer' conjures up images of historic voyages and when you get out onto the open ocean it is difficult not to feel a sense of adventure.

You will take a 35-minute transfer to Luleå from your accommodation at Brändön Lodge or Pinebay Lodge, before picking up a second transfer from Luleå to Piteå, which takes approximately 50 minutes. Following an introduction and safety briefing by the ship's captain, the journey will begin in Pitsundskanalen, which is where the mouth of the river Piteälven meets the open sea. A mere 100 yards ahead of this point, the ocean opens out and there is a seemingly endless display of ice, which is easily broken by the 'Arctic Explorer'. The ship leaves a trail of ocean behind and this makes it possible to bathe in the freezing water.

You will be given survival suits which will provide protection from the cold and also prevents you from getting wet. Following this, you will have the opportunity to float on the water. It is an invigorating experience, and when you are lowered into the ocean you may have feelings of trepidation, but this soon replaced by delight. You can also experience walking upon the thick Ice of the frozen sea, which is a surreal experience, particularly if you imagine the contrast of a summer's day, where the water is flowing freely.

A hot drink and survival suits are included.

Duration: 2 hours cruise (5 hours total, including transfers and preparation time)

Available: 18 Dec 2020 – 04 Apr 2021 on a variety of days Tuesdays and Fridays (start date depends on ice conditions)

Please note: although children of all ages are welcome to join the cruise, due to the availability of survival suits, swimming in the frozen sea is only available for children 7 years and older, or children above the height of 125cm.

Image credit: Graeme Richardson



Aurora hideaway dinner

For an extra special evening during your holiday we highly recommend the Aurora Hideaway Dinner which is a private dining experience. This small hideaway is one of a handful which effectively offers a completely private "restaurant". Each is moved around the archipelago by snowcat to ensure that it is in the best possible location (based on the day's wind, weather and ice conditions).

You will travel via snowmobile-pulled sleigh into the wilds, where you will soon see the glow coming from a small hut in the distance. The heat from a cosy fire will

await you inside.

Upon arrival, you will be served a drink of your choice (either wine, beer or a hot drink – any further drinks can be added to your room bill to be paid at checkout) along with a delicious soup. Your main course will then be prepared on an open fire before pudding and hot drinks are served.

We strongly recommend that between courses you pop outdoors in order to gaze at the sky, as the Northern Lights have been known to interrupt these meals! Your guide will also have snowshoes available for you should you wish to explore the surrounding area (close to the cabin) whilst your next course is being prepared.

If you are booking this activity from Pine Bay Lodge then a short car transfer will be required initially.

Duration: 3 hours (approximately)

Available: 18 Dec 2020 – 04 Apr 2021



Ice fishing

Ice fishing is an incredibly popular activity in the Nordic Countries. You will be led to a fishing spot in a snowmobile-pulled sled.

Your guide will demonstrate how to drill through the ice and set up a fishing line.

It will then be a test of patience and luck to see if you make a catch – perch are commonly caught in the waters here. As you wait, you can sit back with a hot drink and sweet snack.

Duration: 2 hours

Available: 18 Dec 2020 – 04 Apr 2021 (start date depends on ice conditions)

Image credit: Lapland Safaris



Hovercraft tour on the sea ice

An experience which is only available in this part of Swedish Lapland, this hovercraft tour is a genuinely unique means of exploring the Luleå Archipelago. As you are driven along, you can look for sea eagles and seals. There will also be a break to walk over the sea ice and make the most of the outstanding scenery.

Duration: 2.5 hours including lunch

Image credit: Graeme Richardson



© G Richardson

Husky Sledding - Self Drive

Riding a husky sled is definitely one of the most popular activities in Swedish Lapland. Having been transferred to a local husky farm, you will meet the enthusiastic dogs that will pull you along before learning how to control a sled. You will then head off following your guide, travelling two people per sled.

Duration: 2 hours



Lights.

Duration: 3 hours including outdoor dinner

©G Richardson

Northern Lights Snowshoe Walk with Wilderness Dinner

Snowshoes allow you to easily get over areas of deep snow. This is particularly useful when trekking to find the Northern Lights because you will be able to get to less accessible Aurora-spotting locations.

After walking through the snow-covered forest, your guide will prepare a fire and begin cooking your evening meal, as you discuss the science behind the Aurora and learn about the local area. Hot drinks will keep you nice and warm as you look to the skies in search of the Northern



Snowmobile Forest and Nature Tour

Snowmobiling through the snowy forests and frozen sea and lakes of Swedish Lapland is an enchanting and fast-paced experience. Have been shown how to drive the vehicles, you will follow your guide on a trail, travelling two people per snowmobile. It is also possible to upgrade to one person per vehicle.

Anyone wishing to drive a snowmobile must be at least 18 years old and in possession of a full driving licence.

There is a two-hour and a four-hour version of this activity. Stops will be made for tea and coffee along the way, with the four-hour version also featuring lunch.

Duration: 2 hours /4 hours

4-hour safari: Available from 8th January until the 14th April 2021



Snowmobile tour to the Luleå Archipelago Pack Ice

Add some speed to your adventuring with this snowmobile tour around the many islands of Luleå. Following an in-depth briefing on how to safely drive a snowmobile, you will drive behind your guide into the white land. You will travel two people per machine with the opportunity to switch driver and passenger.

You can also upgrade and go one person per snowmobile, getting the full driving experience. Anyone wishing to drive a snowmobile must be at least 18 years old and in possession of a full driving licence.

The ultimate destination on this trip is Brändöskär Island, which has a tranquil fishing village that looks out over pack ice and snow (depending on the weather and snow conditions). There will be a stop along the way and lunch will be prepared over an open fire, and you will head back on snowmobiles.

Duration: 4 hours including lunch

Available: from 08 January until 04 April

Included Accommodation

Brändön Lodge (Nights: 1-2)



Brändön Lodge is located on the edge of the sea that freezes around the Luleå Archipelago each year. It is a remarkable sight to see such a vast frozen mass of water each morning as you step out of your cosy cottage for a day of activities.

Hotel facilities

- Your meals are all served in the restaurant in the main building. You will enjoy a variety of local dishes and more international cuisine in the evening menus (which are typically two courses and served as a hearty buffet). Breakfasts are typically Scandinavian in style and provide you with the fuel that you need for a day of adventure
- The restaurant is situated on the upper floor of the main hotel building and offers panoramic views over the frozen bay while you tuck into your delicious meal
- The lodge also has a fully stocked bar and pretty impressive wine cellar for any enthusiasts staying
- A short walk from the restaurant building, there is also a sauna and hot tub for guests to enjoy. Indulging in a sauna, after an exhilarating day in the great outdoors is just the perfect way to unwind and the hot tub is the cherry on the cake! This is bookable locally and charges apply

Guest room types

Winter cottages: Brändön Lodge consists of individual winter cottages. Each homely cottage is detached, allowing guests the space to unwind and relax in comfort and having all the added benefits of the main building within walking distance.

All the winter cottages have an open plan living and dining area with kitchenette. We recommend taking tea and coffee provisions with you. They have two bedrooms (both furnished with twin beds – in some cases these can be moved together), an en-suite shower room, hairdryer and toilet. Recent room refurbishment leaves the cottages with a modern yet authentic Scandinavian feel. One of the nicest features of the cottages are the terraces, where in the morning you can step out and inhale the

cool, crisp air and marvel at the view of the frozen sea and snow-covered forests that stretch before you.

Image credit: Graeme Richardson, Andrean Walitalo

The Treehotel (Nights: 3)

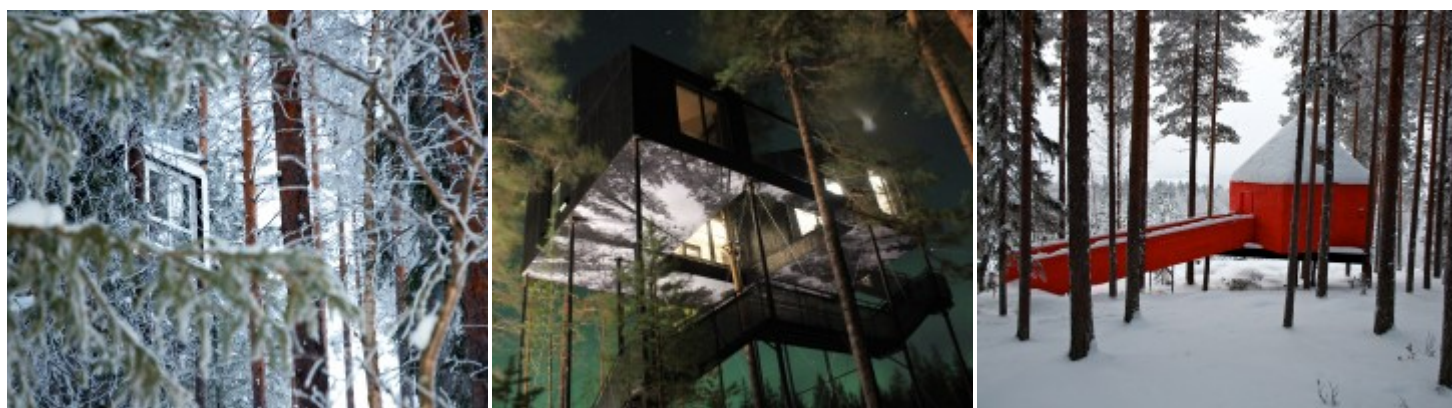

The Treehotel is not only special and unique but also quite surreal. Spending a night in a treetop is an experience that we highly recommend.

Several renowned architects have ensured that the outlandish, yet cutting edge designs fit perfectly in the untouched Lappish forests. All rooms were designed with their location in mind.

Some of the rooms even blend in so well that you can be standing beneath them without realising that they are there.

The accommodation can only be described as 'exclusive', as there are only seven rooms. Given that all the rooms are completely different in design, we thought it would be helpful to provide a more detailed description of each. They all provide a remarkable experience with their own quirks. All include an incinerator toilet and have a supply of water. Drinking water is also supplied. As standard, we include overnight accommodation in either The Bird's Nest, The UFO, or The Blue Cone. The Mirror Cube, The Cabin, Dragonfly and 7th Room, all require a supplement.

Guest bedroom types

The Bird's Nest: One of the most well-known rooms here, the Bird's Nest is camouflaged within the forest. The Bird's Nest has two separate sleeping areas – one double room and then bunk beds, which means that it is suitable for friends or couples. It has a very light interior, with small circular windows. From the outside, the windows are nearly invisible. The nest is accessed by a narrow retractable staircase, therefore, you need to have some confidence with heights to stay here and a level of agility. We recommend taking only the essentials to your rooms and leaving the rest stored securely at Britta's Pension.

The UFO: One of the most spectacular creations at The Treehotel and considered to be a 'big kid's

dream'. To stumble across such a modern spacecraft in the forests of Lapland is surreal. Imagine turning the key to release the access ladder and the ladder descends to a puff of smoke. You would genuinely expect a form of alien life to appear.

Despite being modern in décor, the UFO is very comfortable. It has the capacity to sleep up to five people with a double bed and three singles. There is a living area and your very own computer game to complete the childhood dream.

Access to the UFO is by a retractable and narrow metal ladder, therefore, we recommend this for those who are comfortable with heights and agile. We also suggest taking only the essentials to the room and storing the rest of your luggage at Britta's Pension.

The Mirrorcube: As the room name suggests, the entirely mirror clad exterior means that the room disappears in a camouflage created by the reflection of the landscape in the walls. The cube has been clad in an infra-red film, in order to prevent birds from flying into it. It is a four-metre cube with a birch-clad interior. There are six windows which create an incredible amount of light. Couples can enjoy relaxing in the double bed. The lounge area of the rooftop terrace can be accessed by a ladder. Accessed by a 12-metre long bridge walkway this is one of the most easily accessible rooms.

The Blue Cone: Yes, this is the bright red building. This traditional wooden structure is constructed of laminated birch wood. It has a minimalist interior with reindeer skins accenting the timber clad walls. The views from this room are magnificent and can be enjoyed from the seating area. There is a double room and then a loft sleeping area (which is accessible by ladder) with two single beds. This is one of the most accessible rooms as there is a bridge providing access. It is ideal for those who want to experience staying in a tree room without being too far off the ground.

The Cabin: The interior is a real favourite with guests. It offers a romantic tree top retreat for couples and stunning views across the Luleå River Valley. It is one of the larger rooms at 24 metres square. There is a large double bed, a tree top terrace, which is ideal for soaking up the views. The interior is simple and light. The Cabin is easily accessed via a horizontal bridge. The cabin has a real elegance and the small terrace area is a wonderful place to sit and enjoy the panoramic views of the valley below.

The Dragon Fly: The Dragon Fly is not only the largest room but also the newest addition. It can form a unique meeting venue or an excellent suite for those with a larger party to accommodate.

There is a 15-metre long ramp which provides relatively easy access. The panoramic windows bring the stunning landscape inside. You can sit at the large seating area and absorb the breathtaking views of the valley. The Dragon Fly is equipped with air conditioning and Wi-Fi. There are two rooms here and so it can easily accommodate two couples. A supplement is required when reserving The Dragon Fly, so please see pricing for further details.

The 7th room: The 7th Room is the newest and largest tree room and offers guests a Scandi-style log cabin experience 10 metres up in the air. The inside space consists of two double bedrooms, a sofa bed, lounge and bathroom, which has been furnished in a light and airy style. Outside, guests can climb out onto a net which provides patio space which provides views over the stunning Swedish valley below.

Other Facilities

- The Tree Sauna –this is an exhilarating experience, where you can pay locally for a two-hour visit to the sauna and relaxation area. A hot tub is also available for rental at an additional charge
- Showers are located in a separate building a couple of minute's walk from the rooms
- Your meals will be served at Britta's Pension (guesthouse). The cosy dining area is full of character furniture and quirky charm. All meals are full of local home cooking. Hearty and warming meals enhance the welcoming atmosphere at Britta's
- It is around a 10-minute walk uphill from Britta's to the area which houses the tree rooms. Britta's Pension also serves as the reception for The Treehotel. Britta and her husband Kent own the Treehotel. The guesthouse is Britta's pride and joy and it is easy to see how passionate both Britta and Kent are about the local area and their wonderfully unique, innovative and quirky accommodation.

Please note: Prices are based on you staying in either The Bird's Nest, The UFO, or The Blue Cone.

Image credit: Graeme Richardson and Treehotel

The Specifics

Holiday group size (approximate)

Minimum 2, maximum 24 (approximately)

Group Size

We always try to provide an approximation of the group size you can expect to be with for the duration of each of our holidays. It may be that you are joined by others for parts of your holiday (such as transfers and particular activities) but the above number reflects those you can normally expect to be with from beginning to end. If group size is something which is particularly important to you, please speak to our Travel Experts and they can suggest the best holidays for you.

Tailor-made holiday group sizes will vary for all activities as will the group size for any additional activities you book.

Minimum numbers required for a holiday to operate

Some of our holidays require a minimum number of participants to operate (as listed in the 'Group Size' section). If your holiday departure has not yet reached the minimum number, you will be told at the time of booking. In the unlikely event that your chosen date is not guaranteed by nine weeks before your scheduled departure date, we will contact you to discuss the available options as per

our [booking conditions](#).

Minimum and maximum age

If a specific minimum age applies to this holiday, it can be found in the Key Facts box on the holiday Overview page.

Unless otherwise stated in the Key Facts box on the holiday Overview page, the minimum age for participation in an Aurora Zone holiday is typically 12 years old (there may be younger children in some destinations who have booked with other companies). If an adult-only environment is important to you, then please contact our Travel Experts and they will advise on the best dates and destinations for you. If you are looking for a holiday designed specifically for families then please see our sister company www.activitiesabroad.com.

Itinerary amendments

The order of activities listed in this agenda is provided for guidance only, your final and detailed itinerary will be provided either with your final travel documents (which are uploaded into your online account around a week prior to departure) or upon arrival.

Terms and Conditions

Our full booking terms and conditions can be found on our website: <https://www.theaurorazone.com/booking-conditions>